

**vtech**<sup>®</sup>  
Baby

User's Manual

# Toot-Toot Drivers

## Car Carrier



© 2012 VTech  
Printed in China  
91-002764-001 UK

**VTech understands that a child's needs and abilities change as they grow and with that in mind we develop our toys to teach and entertain at just the right level...**

## **vtech** Baby

**Toys that will stimulate their interest in different textures, sounds and colours**

### **I am...**

...responding to colours, sounds and textures

...understanding cause and effect

...learning to touch, reach, grasp, sit-up, crawl and toddle

**Birth-36 months**



## **Pre-School**

**Interactive toys to develop their imagination and encourage language development**

### **I want...**

...to get ready for school by starting to learn the alphabet and counting

...my learning to be as fun, easy and exciting as can be

...to show my creativity with drawing and music so my whole brain develops

**3-6 years**



## **Electronic Learning Computers**

**Cool, aspirational and inspiring computers for curriculum related learning**

### **I need...**

...challenging activities that can keep pace with my growing mind

...intelligent technology that adapts to my level of learning

...National Curriculum based content to support what I'm learning at school

**4-10 years**



To learn more about this and other VTech® products, visit [www.vtechuk.com](http://www.vtechuk.com)

# INTRODUCTION

Thank you for purchasing the **VTech® Toot-Toot Drivers Car Carrier** learning toy!

The **Toot-Toot Drivers Car Carrier** is a big truck with big style! This car carrier comes with one vehicle and can hold up to six Toot-Toot Drivers vehicles (sold separately). With its drop-down ramp and back gate, your child will love loading up the car carrier as they pretend and play. For added interaction, this truck recognises all Toot-Toot Drivers vehicles and has three shape buttons and a number pad that introduce numbers and colours!

FLIP-DOWN  
GATE

SPINNING GEARS  
TO LOWER RAMP

ROLE-PLAY  
BUTTONS

WINDSCREEN

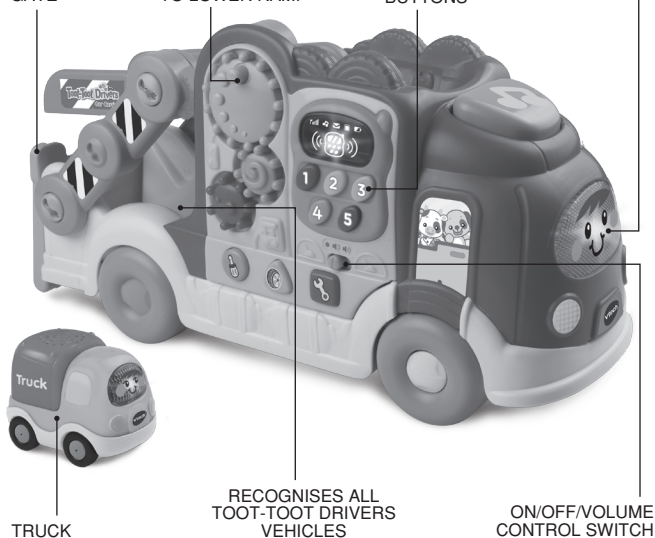

# INCLUDED IN THIS PACKAGE

- One VTech® Toot-Toot Drivers Car Carrier
- One user's manual
- One truck

## WARNING:

All packing materials, such as tape, plastic sheets, packaging locks and tags are not part of this toy, and should be discarded for your child's safety.

## NOTE:

Please keep user's manual as it contains important information.

Please cut and discard the plastic tie between the ramp and the top platform before playing with the unit. This plastic tie is not part of the product and should be discarded for your child's safety.



# GETTING STARTED

## BATTERY INSTALLATION

1. Make sure the unit is turned OFF.
2. Locate the battery cover on the bottom of the car carrier. Use a coin or a screwdriver to loosen the screw.
3. Install 2 new 'AA' (AM-3/LR6) batteries following the diagram inside the main unit battery box(a). Install 1 new 'AA' (AM-3/LR6) battery following the diagram inside the truck battery box(b). (The use of new alkaline batteries is recommended for maximum performance.)
4. Replace the battery cover and tighten the screw to secure.

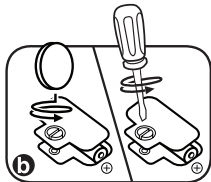
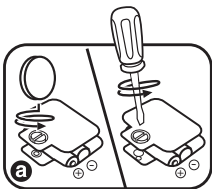

## BATTERY NOTICE

- Use new alkaline batteries for maximum performance.
- Use only batteries of the same or equivalent type as recommended.
- Do not mix different types of batteries: alkaline, standard (carbon-zinc) or rechargeable (Ni-Cd, Ni-MH), or new and used batteries.
- Do not use damaged batteries.
- Insert batteries with the correct polarity.
- Do not short-circuit the battery terminals.
- Remove exhausted batteries from the toy.
- Remove batteries during long periods of non-use.
- Do not dispose of batteries in fire.
- Do not charge non-rechargeable batteries.
- Remove rechargeable batteries from the toy before charging (if removable).
- Rechargeable batteries are only to be charged under adult supervision.

## Disposal of batteries and product



The crossed-out wheellie bin symbols on products and batteries, or on their respective packaging, indicates they must not be disposed of in domestic waste as they contain substances that can be damaging to the environment and human health.

The chemical symbols Hg, Cd or Pb, where marked, indicate that the battery contains more than the specified value of mercury (Hg), cadmium (Cd) or lead (Pb) set out in Battery Directive (2006/66/EC).





The solid bar indicates that the product was placed on the market after 13th August, 2005.

Help protect the environment by disposing of your product or batteries responsibly.

For more information, please visit:  
[www.recycle-more.co.uk](http://www.recycle-more.co.uk)  
[www.recyclenow.com](http://www.recyclenow.com)

# PRODUCT FEATURES

## 1. ON/OFF/VOLUME CONTROL SWITCH

To turn the unit **ON**, slide the **ON/OFF/VOLUME CONTROL SWITCH** to the **LOW VOLUME** (  ) or the **HIGH VOLUME** (  ) position. To turn the unit **OFF**, slide the **ON/OFF/VOLUME CONTROL SWITCH** to the **OFF** (  ) position.



## 2. AUTOMATIC SHUT-OFF

To preserve battery life, the **VTech® Toot-Toot Driver Car Carrier** will automatically power-down after approximately 30 seconds without input. The unit can be turned on again by pressing any button.



# ACTIVITIES

1. Slide the **ON/Off/Volume Control Switch** to turn on the unit. You will hear a sing-along song, a phrase and a sound effect. The lights will flash with the sounds.



2. Press the **Button** on the roof of the car carrier to hear sounds, a phrase, a short tune, fun music and a sing-along song. The lights will flash with the sounds.

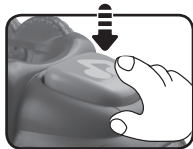

3. Press the **Number Buttons** and you will hear phone sounds, numbers, colours, phrases, fun sounds and short tunes. The light on the phone screen will flash with the sounds.



4. Press the three **Shape/Tool Buttons** to learn shapes and phrases about using the tools to fix the car carrier. The light on the phone screen will flash with the sounds.



5. Drop down/push up the **Ramp** to hear sounds and phrases. The lights will flash with the sounds.

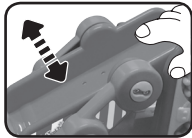

6. Turn the **Gears** to hear fun sounds and see the ramp drop down. The lights will flash with the sounds.

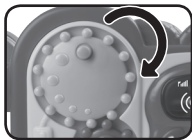

7. While a vehicle is on the recognition sensor, press down or quickly push the vehicle through the gate to hear a greeting. The lights will flash with the sounds.



8. If a melody is playing, push the car carrier to hear fun sounds. If no other response is playing, push the car carrier to hear fun sounds and music.

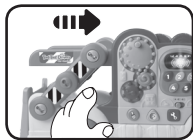

9. After a vehicle has been recognised and the car carrier sits idle for approximately 8 seconds, you will hear a reminder to find that vehicle. If no vehicle has passed through the recognition sensor and the unit sits idle for approximately 8 seconds, you will hear sound effects and a sing-along song. If there is still no input for another 8 seconds, you will hear a closing short tune, and the unit will go into sleep mode. The unit can be re-activated by pressing any button except the recognition sensor.

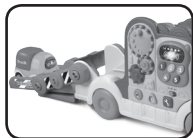

## MELODY LIST

1. I've Been Working on the Railroad
2. London Bridge
3. Three Blind Mice
4. It's Raining, It's Pouring
5. Humpty Dumpty
6. Old King Cole

## SUNG SONG LYRICS

Carry vehicles around the town.  
Load them up, then roll them down.  
Driving, learning along the way.  
Learning's so much fun today!



# CARE & MAINTENANCE

1. Keep the unit clean by wiping it with a slightly damp cloth.
2. Keep the unit out of direct sunlight and away from any direct heat source.
3. Remove the batteries when the unit is not in use for an extended period of time.
4. Do not drop the unit on hard surfaces and do not expose the unit to moisture or water.

# TROUBLESHOOTING

If for some reason the program/activity stops working or malfunctions, please follow these steps:

1. Please turn the unit **OFF**.
2. Interrupt the power supply by removing the batteries.
3. Let the unit stand for a few minutes, then replace the batteries.
4. Turn the unit **ON**. The unit should now be ready to play again.
5. If the product still does not work, replace with an entire new set of batteries.

If the problem persists, please call our Consumer Services Department on 01235 546810 (from UK) or +44 1235 546810 (outside UK) and a service representative will be happy to help you.

## **IMPORTANT NOTE:**

Creating and developing **VTech®** products is accompanied by a responsibility that we take very seriously. We make every effort to ensure the accuracy of the information, which forms the value of our products. However, errors sometimes can occur. It is important for you to know that we stand behind our products and encourage you to call our Consumer Services Department on 01235 546810 (from UK) or +44 1235 546810 (outside UK), with any problems and/or suggestions that you might have. A service representative will be happy to help you.

CLASS 1  
LED PRODUCT



## PRODUCT WARRANTY



Thank you for choosing this quality product from VTech. We hope it will bring many hours of entertainment, imaginative play and learning.

1. The product detailed above is covered by a one year warranty from the date of purchase, against any defects in materials or workmanship.
2. The product may be returned to the place of purchase. Alternatively the product can be returned to VTech Electronics Europe plc (see address below), with proof of purchase, without proof of purchase no replacement will be provided.
3. VTech Electronics Europe plc will examine the product and if it is found to be defective due to faulty materials or workmanship, will replace the product at their discretion.
4. If the product covered by this warranty is damaged due to misuse, modification or unauthorised repair, or because of faulty batteries, battery discharge or incorrect electrical connections, then this warranty becomes void.
5. This warranty is personal to the original purchaser and is not transferable.
6. Breakages to the LCD screen are not covered by the warranty.
7. Returns to VTech Electronics Europe plc should include a cheque or postal order for £1.50 towards the cost of return postage and packaging.
8. Products returned to VTech Electronics Europe plc, should be addressed as follows and packed carefully to avoid damage in transit (Please do not include batteries or adaptor).  
Please include details of the fault together with your name and address.

VTech Electronics Europe plc, c/o Tablogix Limited, 200 Milton Park, Abingdon, Oxon OX14 4TA

**THIS WARRANTY IS OFFERED AS AN EXTRA BENEFIT AND DOES NOT AFFECT CONSUMERS' STATUTORY RIGHTS.**

This warranty is valid for the UK and Eire only. For products purchased outside the UK and Eire, please contact your local distributor or place of purchase.

